

AGON MINI 1

IP67 IK08 CE   WP   | A > A+ > A++

TIPOLOGIA / TYPOLOGY

Incasso | Recessed

POSIZIONE INSTALLATIVA | INSTALLATION POSITION

A terra | Floor mounting

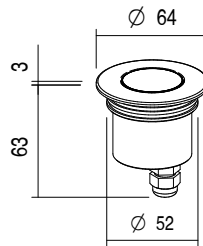

AMBIENTE INSTALLATIVO | INSTALLATION LOCATION

Esterno | Outdoor



AGON MINI 1

4W

 Finish .01 .08 .09
kg 0,23 Finish .06 .10
kg 0,31

AGON MINI 1

CARATTERISTICHE ELETTRICHE | ELECTRICAL FEATURES

POTENZA ASSORBITA POWER CONSUMPTION	4W
ALIMENTAZIONE POWER SUPPLY	230Vac
FREQUENZA FREQUENCY	50/60 Hz
ALIMENTATORE POWER SUPPLY UNIT	Integrato Integrated
COLLEGAMENTO CONNECTION	Tensione di rete Mains voltage

CARATTERISTICHE ILLUMINOTECNICHE | LIGHTING FEATURES

COLORE LED LED COLOUR	2700K, 3000K, 4000K
INDICE RESA CROMATICA CRI CRI	>80
BINNING	3 step MacAdam 3 MacAdam steps
OTTICHE OPTICS	18°, 24°, 36°, Diffused, 60°
FLUSSO REALE EMESSO - 3000K REAL OUTPUT FLUX	4W 275lm 36°
DURATA MEDIA LED AVERAGE LED LIFE	50.000h L80 B10

CARATTERISTICHE MECCANICHE | MECHANICAL FEATURES

PESO WEIGHT	Finishing .01 .08 .09: kg 0,23 - Finishing .06 .10: kg 0,31
FINITURE FINISHES	Alluminio anodizzato, Acciaio Inox, Nero TXT, Corten, Acciaio Spazzolato Anodized aluminium, Steel, TXT Black, Corten, Brushed Steel Su richiesta
INSTALLAZIONE INSTALLATION	A incasso a terra con cassaforma (non inclusa) Recessed on ground with housing box (not included)
MATERIALE MATERIAL	Corpo in alluminio anticorrosivo, ghiera in acciaio inox AISI 316L, vetro temperato trasparente e lente in PMMA Anticorrosive aluminium body, AISI 316L stainless steel trim, transparent tempered glass and PMMA lens

CARATTERISTICHE GENERALI | GENERAL FEATURES

TEMPERATURA DI ESERCIZIO OPERATING TEMPERATURE	-10°C +45°C
GRADO DI PROTEZIONE INGRESS PROTECTION	IP67
GRADO DI RESISTENZA IMPACT RESISTANCE	IK08
GLOW WIRE TEST GLOW WIRE TEST	960°C
TEMPERATURA MASSIMA APPARECCHIO MAX. TEMPERATURE OF FIXTURE	50° @ Ta = 25°
CLASSE DI ISOLAMENTO APPLIANCE CLASS	I
CALPESTABILE WALKOVER	Sì / Yes
CARRABILE DRIVE OVER	2000 Kg
SICUREZZA STANDARD STANDARD SAFETY	WP System
SICUREZZA FOTOBIOLOGICA PHOTOBIOLOGICAL SAFETY	GR1

AGON MINI 1

ACCESSORI | ACCESSORIES

CODICE / CODE	CAW32	
TIPOLOGIA / TYPOLOGY	Cassaforma <i>Housing box</i>	 kg 0,09
MATERIALE / MATERIAL	PVC	

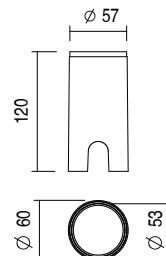

CODICE / CODE	CAI32	
TIPOLOGIA / TYPOLOGY	Cassaforma <i>Housing box</i>	 kg 0,06
MATERIALE / MATERIAL	ABS	

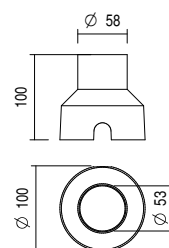

FILTRI | FILTER

CODICE / CODE	HC	
TIPOLOGIA / TYPOLOGY	Filtro Honeycomb <i>Honeycomb filter</i>	
NOTE	<i>with 18°, 24°, 36°, 60° lens only</i>	

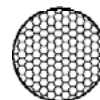

CODICE / CODE	BC	
TIPOLOGIA / TYPOLOGY	Filtro Black & Clear <i>Black & Clear filter</i>	
NOTE	<i>with 18°, 24°, 36°, 60° lens only</i>	



CODICE / CODE	BD	
TIPOLOGIA / TYPOLOGY	Filtro Black & Diffused <i>Black & Diffused filter</i>	
NOTE	<i>with diffused lens only</i>	



a scelta | to be chosen